

**SUNFLEX UK** ✪



Sliding doors



- Bifold doors
- Sliding doors
- Slide & Turn doors
- Windows
- Rooflights
- Glass roofs
- Front doors
- French doors
- Moveable walls
- Commercial glazing

## AWARD-WINNING PRODUCTS, DESIGNED EXCLUSIVELY FOR YOU

### Heritage

SUNFLEX has been manufacturing doors for more than 30 years. This experience enables us to understand not only how to make the best doors possible, but also how to ensure that our customers are happy with them – not just when they're installed but for many years to come.

### Innovation

For more than three decades, our constant innovations have created products that don't just look good, they perform perfectly too. Each one of our products, available in the widest range of configurations, is designed to be the best it can be, without compromise.

### Quality

When only the best will do, it has to be SUNFLEX. We understand that changing your home is a big commitment and that you want the best system available. Each SUNFLEX product is manufactured to exacting standards at the forefront of the industry, working with tried and trusted partners to ensure the highest quality of service.

### Performance

Whether you choose our systems because of their smooth operation, advanced thermal standards, highest quality of manufacture or rigorous independent security testing, you are safe in the knowledge that our products are designed to perform, day after day, year after year.

### Detail

Each one of our products is designed with attention to detail and a whole range of unique features. Many of today's industry-standard features were first seen on previous generations of SUNFLEX products. It is no exaggeration to say that we lead and others follow.

## INDUSTRY LEADING GLAZING SOLUTIONS

For more than 30 years SUNFLEX has designed, engineered and manufactured exclusive glazing products.

From the very beginning, our doors have had the uncompromising quality, unique features, performance and attention to detail that sets them apart from all others.

SUNFLEX UK offers the perfect combination of outstanding British design and state-of-the-art German engineering to create industry-leading bifold doors, sliding doors and glass solutions. Each product supplied by SUNFLEX UK embraces the most advanced materials and the latest cutting-edge manufacturing techniques to create award-winning products.

SUNFLEX UK and our products include a number of external certifications and awards, including:



# SLIDING DOORS SVG30

NEW Ultra-slim aluminium sliding door

SVG30 cross section

The SUNFLEX UK SVG30 combines incredibly slim intermediate frames of just 30mm with advanced engineering and smooth operation to create the perfect system for large glazed openings.

Whichever angle you view the doors from the SVG30 offers narrow sightlines making the system ideal for breaking down the boundaries between inside and out and flooding your home full of natural light. The versatile design allows for large panes of glass while maintaining the ease of use, advanced security and superior product quality for which our glazing products are renowned.

With individual panel widths of up to 3m wide and available in a range of configurations from a single panel door sliding on an extended track into a pocket all the way up to an overall system width of 24m, each set of doors is manufactured to your exact specifications including the choice of tracks, handle options and more than 200 colours and finishes.

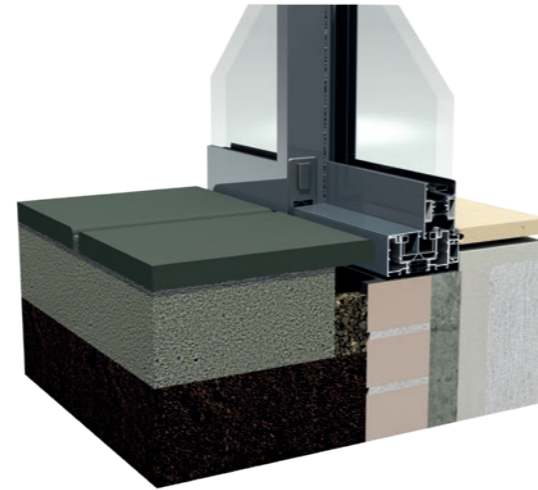

## Key features

- Ultra-slim frame of just 30mm with no requirements for external reinforcing profile, reducing the sightlines when viewed from any angle.
- PAS 24: 2016 and Secured by Design accredited
- Quality assured to prestigious BSI Kitemark™ standards
- U-values as low as 1.6Wm<sup>2</sup>K double glazed with a centre pane of 1.0 Wm<sup>2</sup>k.
- Versatile panel widths from 800mm to 3 metres wide and up to 2.8m high depending on width.
- Independently weather tested to severe weather rating – Class 7a (300Pa) water tightness, Class 3 (600Pa) air permeability, Wind class AE (2,400Pa) wind loading.
- Flush stacking allowing each panel to stack completely behind the next.
- Excellent security with five-point mushroom headed cam bolts and claw lock.
- Advanced engineering provides a stunning appearance and effortlessly smooth running.
- A wide range of configuration options including moveable corner posts and extended tracks that mean the doors can be tailored to your exact requirements.
- Available in more than 200 RAL colours textured finishes ensuring the doors perfectly complement your home.
- Choose from colour matched D handles, stainless steel feature handles or recessed handles.
- Available in lift and slide option for the lead door.





## SLIDING DOORS SVG83

Highly engineered, hugely popular aluminium sliding doors

SVG83 cross section

With contemporary square edge 83mm profile and extreme panel sizes of up to 3m in width the SVG83 is one of the most popular systems in the SUNFLEX UK range.

The highly engineered doors offer the ultimate in smooth, effortless operation and are ideal for creating large glazed openings in any type of project, from extensions and renovations to complete new-build homes. The SVG83 offers the highest levels of manufacturing quality, security and protection from the elements; and can be configured to your exact requirements.

Additional reinforcing sections ensure even the largest panels are suitable for the harshest of climates without increasing the sightlines, whilst the fully recessed level (DDA compliant) threshold is achievable without compromising the weather proofing of the doors. The SVG83 is available as a lift and slide system, which means it can be secured in place when partially opened or configured to include moveable corner posts and with multiple track options, including extended tracks to open into a pocket.



### Key features

- Available in more than 200 RAL colours textured finishes ensuring the doors perfectly complement your home.
- PAS 24: 2016 and Secured by Design accredited
- Quality assured to prestigious BSI Kitemark™ standards
- Advanced engineering ensures effortlessly smooth running.
- Designed with anti-lift blocks and a continuous locking bar that accommodates a five-point mushroom bolt and claw lock.
- Extreme panel sizes of up to 3m wide with total overall openings of up to 24m achievable.
- Severe weather rating Class 7a (300Pa) water tightness, Class 3 (600Pa) air permeability, Wind class AE (2,400Pa) wind loading.
- Available with recessed twin or triple tracks
- Achieves a U-value as low as 1.4Wm<sup>2</sup>K triple glazed (1.6Wm<sup>2</sup>K when double glazed).
- Available in lift and slide option for the lead door.
- Heavy duty design available with extended track and moveable corner post options.
- Choose from colour matched D handles, stainless steel feature handles or recessed handles.

# SLIDING DOORS POCKET SLIDER

Pocket sliding doors are the latest innovation in sliding door technology. Whereas a sliding door within a standard configuration would see panels slide behind a fixed frame that sits within the opening, with a pocket sliding door you are able to slide all of the panels on an extended track into a cavity in the wall – creating a complete, unobstructed aperture that seamlessly connects your home and garden when the doors are fully opened, yet with large glass panels and slim aluminium frames that are perfect for letting in light when closed.

Our pocket sliding doors are available utilising the panels of either of our sliding door systems, the SVG30 with incredibly narrow 30mm intermediate frames or the SVG83 with 83mm sightlines. With a completely flush track achievable and super-smooth operation as standard our exclusive pocket sliding doors are perfectly suited for new-build or extension projects and create a real design feature and 'wow' factor for any home.



## Key features

- Available utilising the panels of either our SVG30 or SVG83 systems
- Versatile panel widths from 800mm to 3 metres wide and up to 2.8m high depending on width.
- Quality assured to prestigious BSI Kitemark™ standards
- Independently weather tested to severe weather rating Class 7a (300Pa) water tightness, Class 3 (600Pa) air permeability, Wind class AE (2,400Pa) wind loading.
- Creates a real 'wow' factor for projects, seamlessly connecting the house and garden when doors are opened.
- PAS 24: 2016 and Secured by Design accredited
- Excellent security with five-point mushroom headed cam bolts and claw lock.
- U-values as low as 1.6Wm<sup>2</sup>K double glazed with a centre pane of 1.0 W/m<sup>2</sup>k.
- Advanced engineering provides a stunning appearance and effortlessly smooth running.
- A wide range of configuration options available from a single panel sliding door up to 6 panels (3-left, 3-right) with 18m overall width.
- Available in more than 200 RAL colours textured finishes ensuring the doors perfectly complement your home.
- Choose from colour matched D handles, stainless steel feature handles or recessed handles.

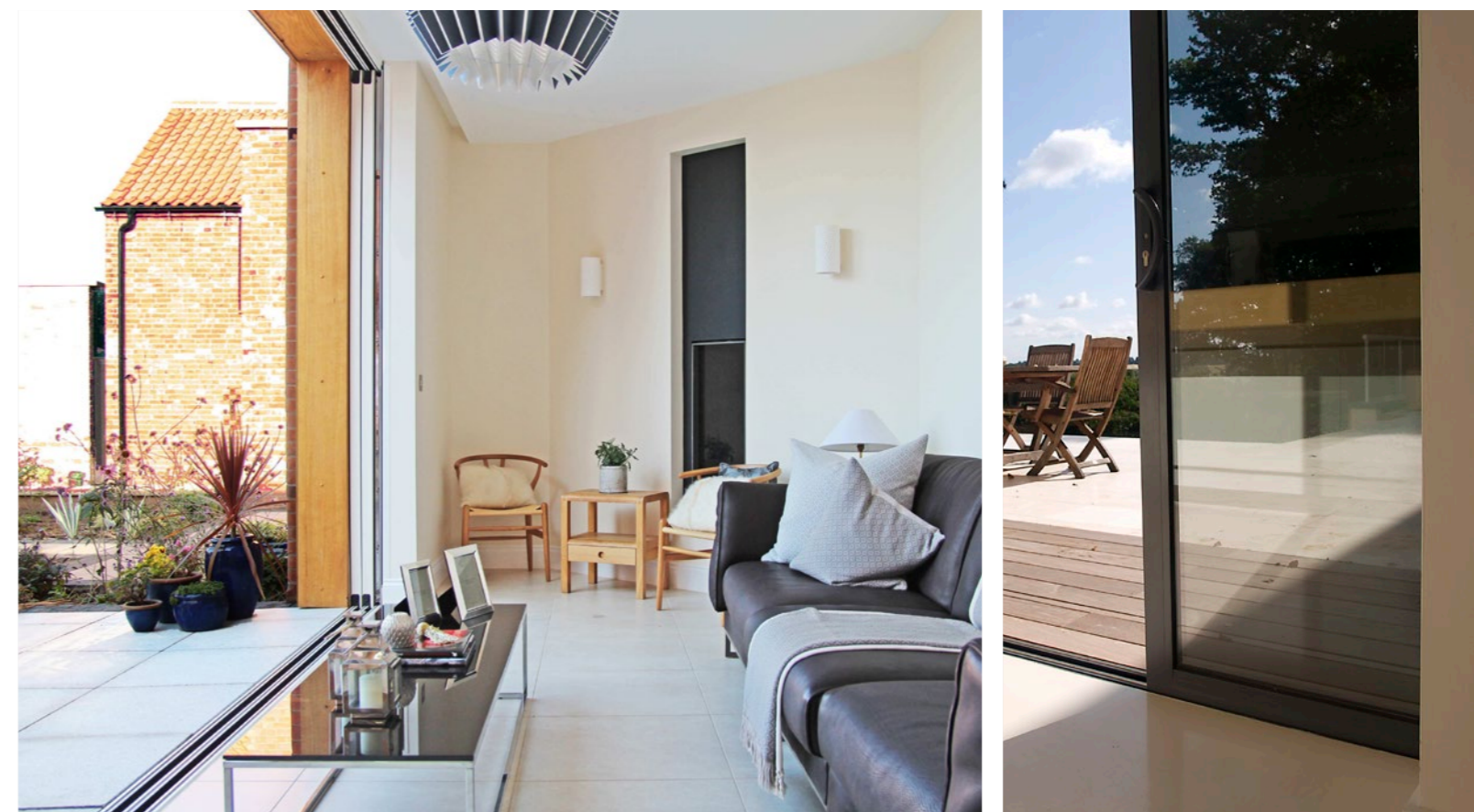

# HANDLE OPTIONS

Round feature handle  
(polished stainless steel)

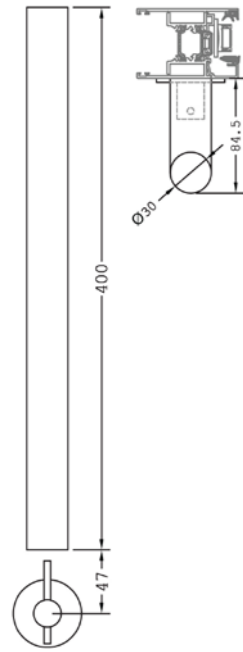

Rectangular feature handle  
(brushed stainless steel)

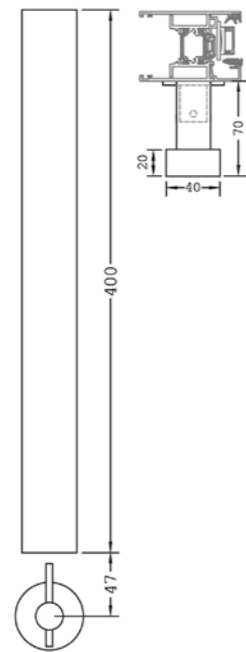

D-shaped handle  
(colour coded)

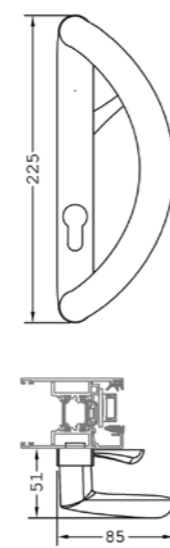

Recessed handle  
(colour coded)



As standard both the SVG30 and SVG83 are available with a D-shaped handle colour matched to the frame of the doors, with the stylish round or rectangular stainless steel feature handles available as an optional upgrade. It is also possible to fit the doors with a colour matched recessed handle.

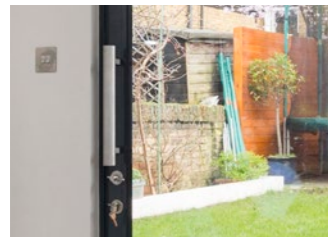

Round feature handle

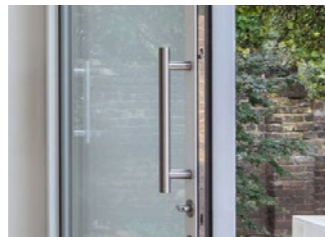

Rectangular feature handle

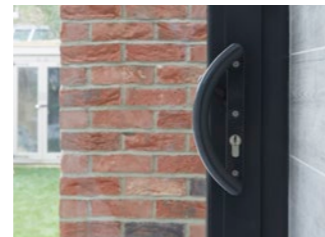

D-shaped handle



Recessed handle

# THERMAL AND WEATHER PERFORMANCE

SVG30 and SVG83

U-value of glass (Wm <sup>2</sup> /K)	Overall system U-value (Wm <sup>2</sup> /K)
1.0 Double glazed	1.6
0.7 Triple glazed	1.4

Weather test	Performance
Air permeability BS EN 12207	Class 3 600 Pascals
Water tightness BS EN 1027	Class 7A 300 Pascals
Wind load BS EN 12211	Class AE 2,400 Pascals

# TECHNICAL DETAILS

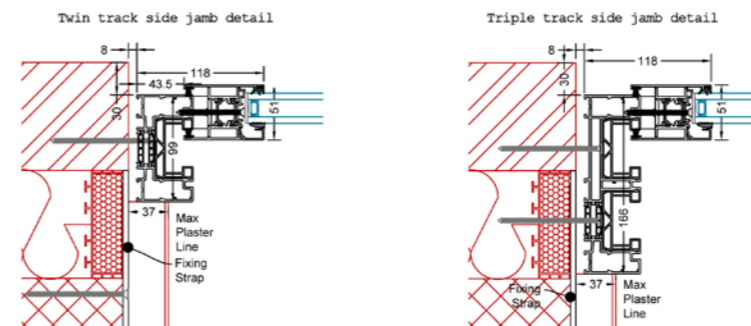
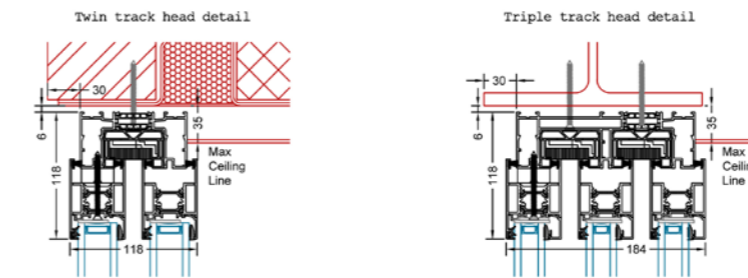
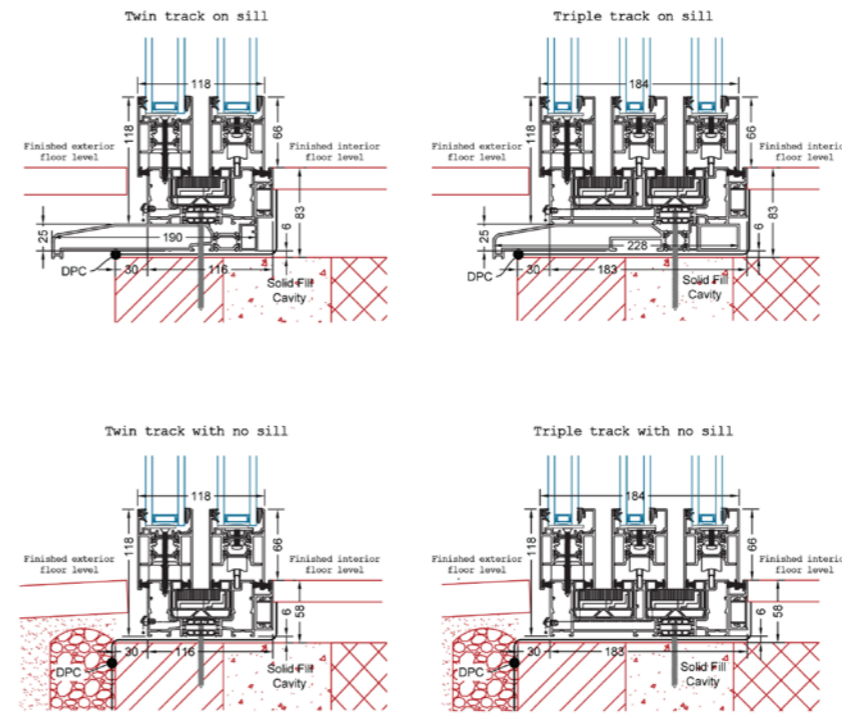

## RAL colours

Alternatively you can select from more than 200 RAL colours, including the option to have the doors a different colour on the internal and external face of the door, perfect if you are trying to match interior décor and exterior finishes.

# COLOURS

Choose from one of three standard RAL finishes or opt for a custom coloured frame to perfectly complement your project. The three popular standard colours and finishes are:

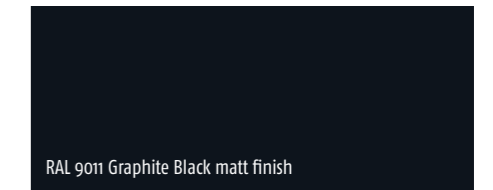

Our most popular non-standard colours include

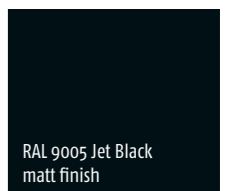
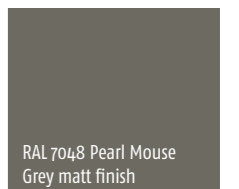
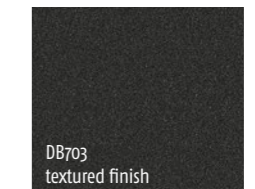

Heritage

Innovation

Quality

Performance

Detail

**SUNFLEX UK** 

[sunflexUK.co.uk](http://sunflexUK.co.uk)